

Note: See also "Recommended PCB Drawing to fit ECB25B1 Enclosure"

Divots for case mounting (2 PLCS)
Drill Out $\phi 1/8"$
Use #4 Flat Head

Base

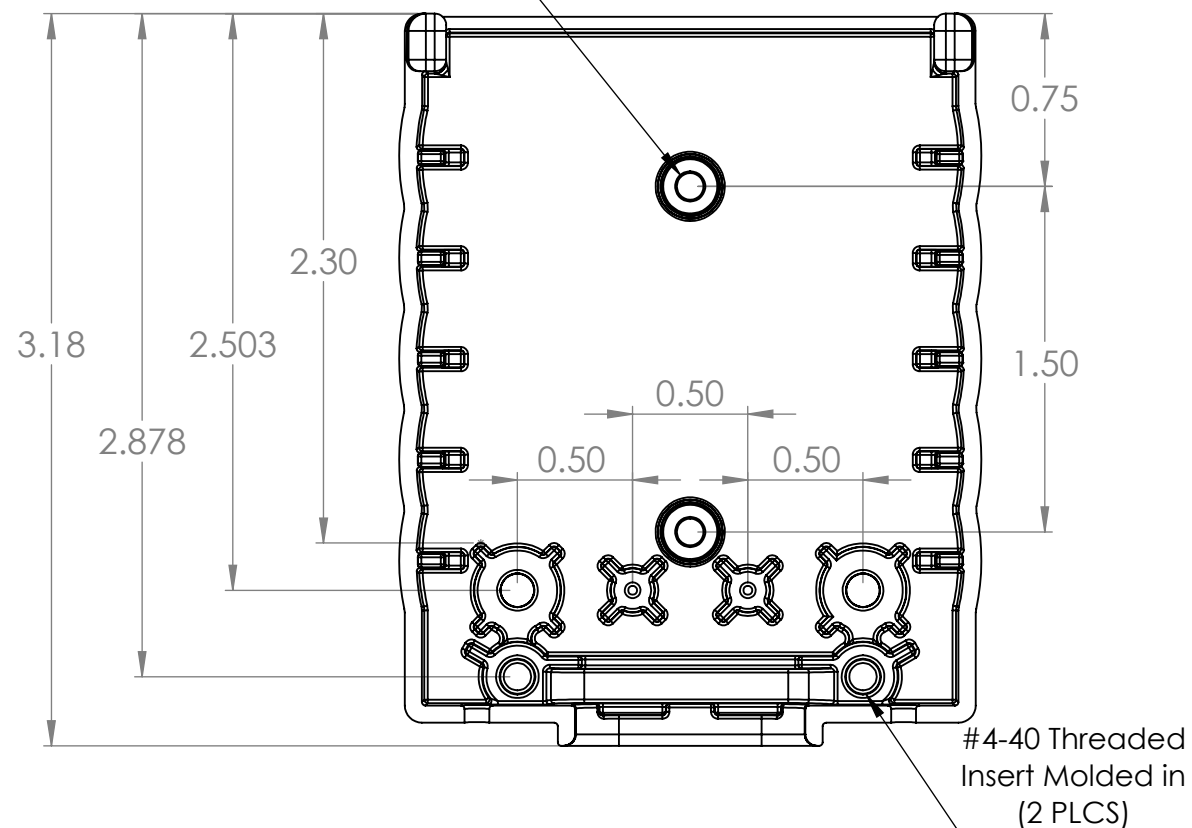

Cover

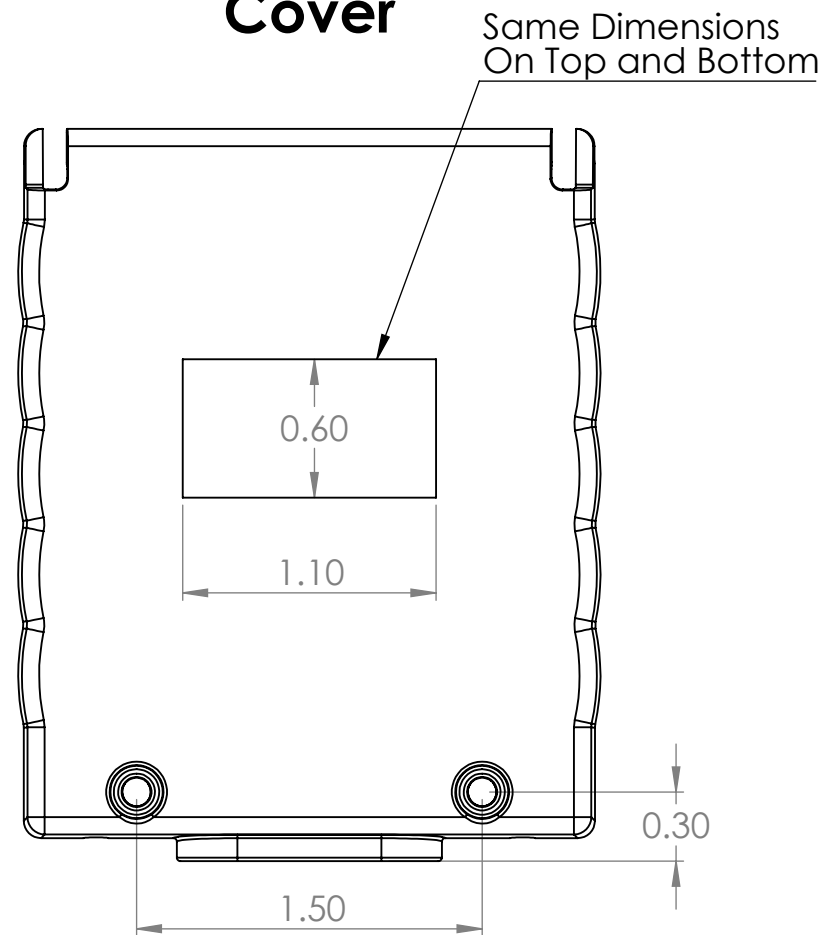

#4-40 Pan-Head, 5/8" For Case Enclosure (Qty:2)	
3.5MM OD x 5.5MM Snap Rivet For PCB Mounting (Qty: 2)	
0.1" Zip Tie, 4" For Wire Strain Relief (Qty:1)	

Front Assembly

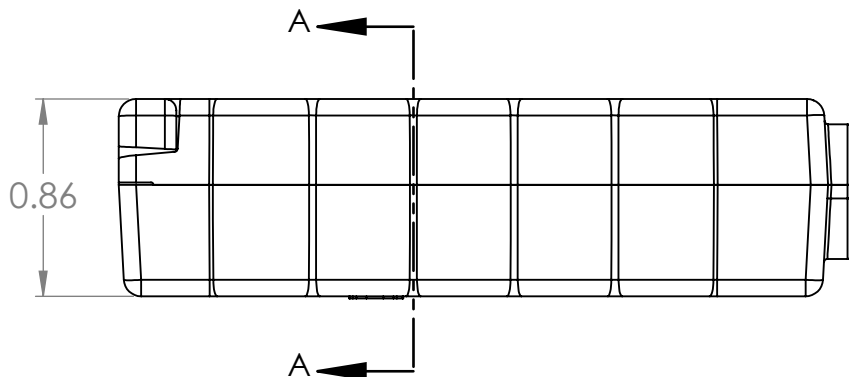
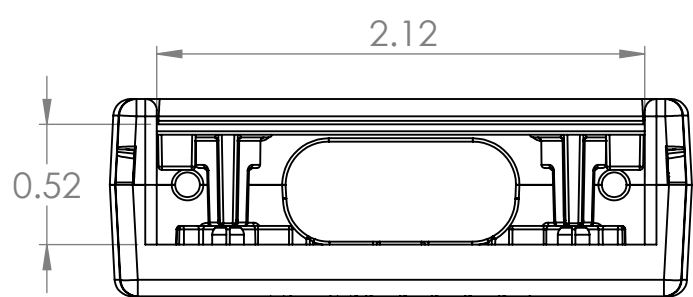

Back Assembly

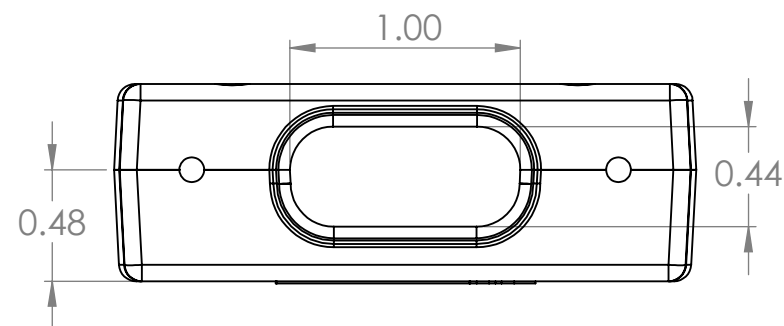

SECTION A-A

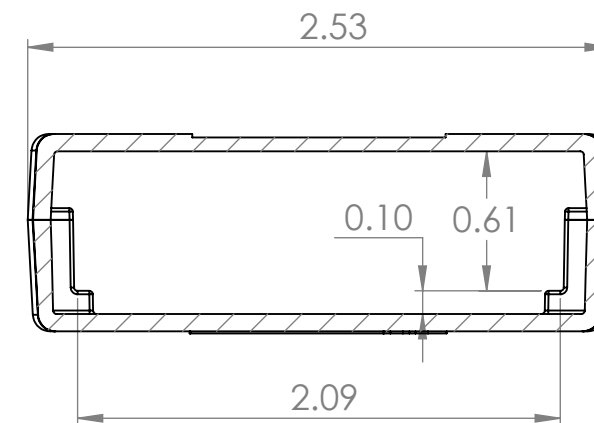

DIM: INCH	DATE: 02/25/2025	RoHS COMPLIANT: Yes	DESCRIPTION:
WINFORD ENGINEERING, LLC 4561 GARFIELD ROAD AUBURN, MI 48611 www.winford.com			DB44HD PCB Enclosure Kit
			PART NUMBER (S) ECB25B1-N
		989-671-9721	