

Note: See also "Recommended PCB Drawing to fit ECB25B1 Enclosure"

Divots for case mounting (2 PLCS)  
Drill Out  $\phi 1/8"$   
Use #4 Flat Head

### Base

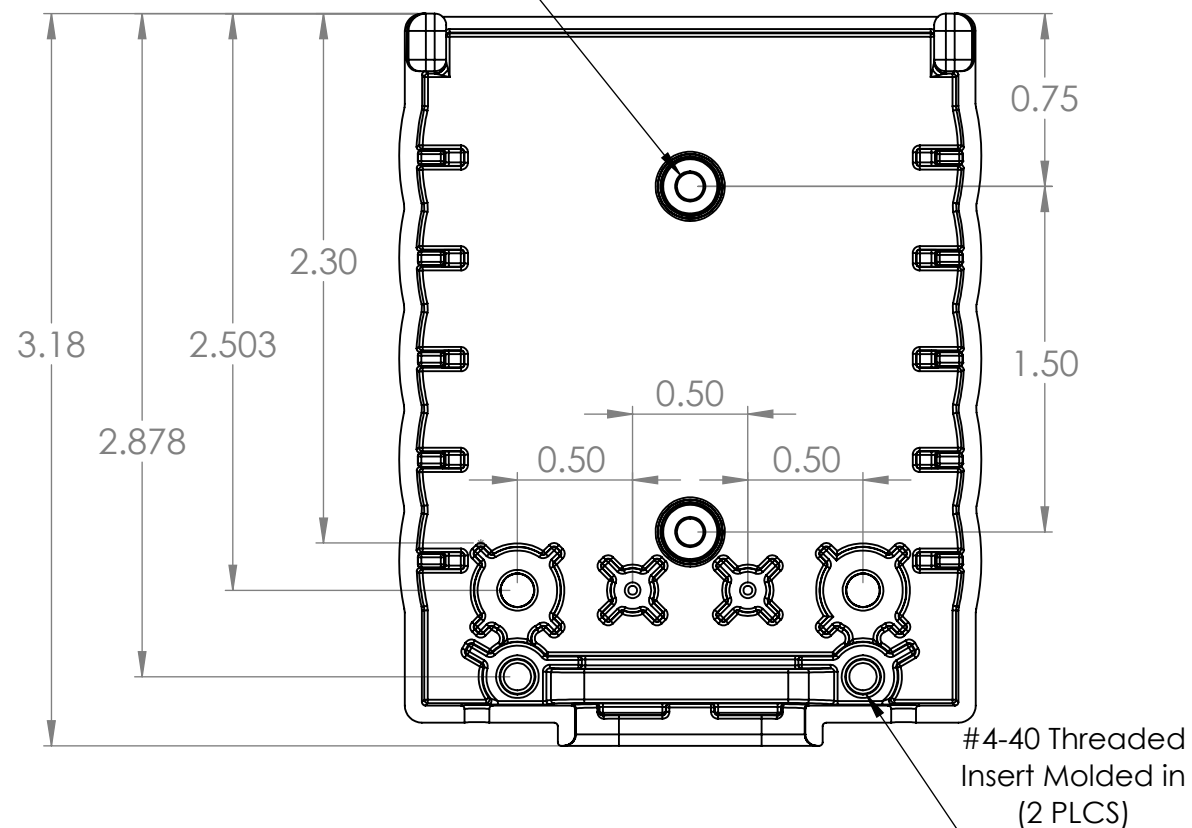

### Cover

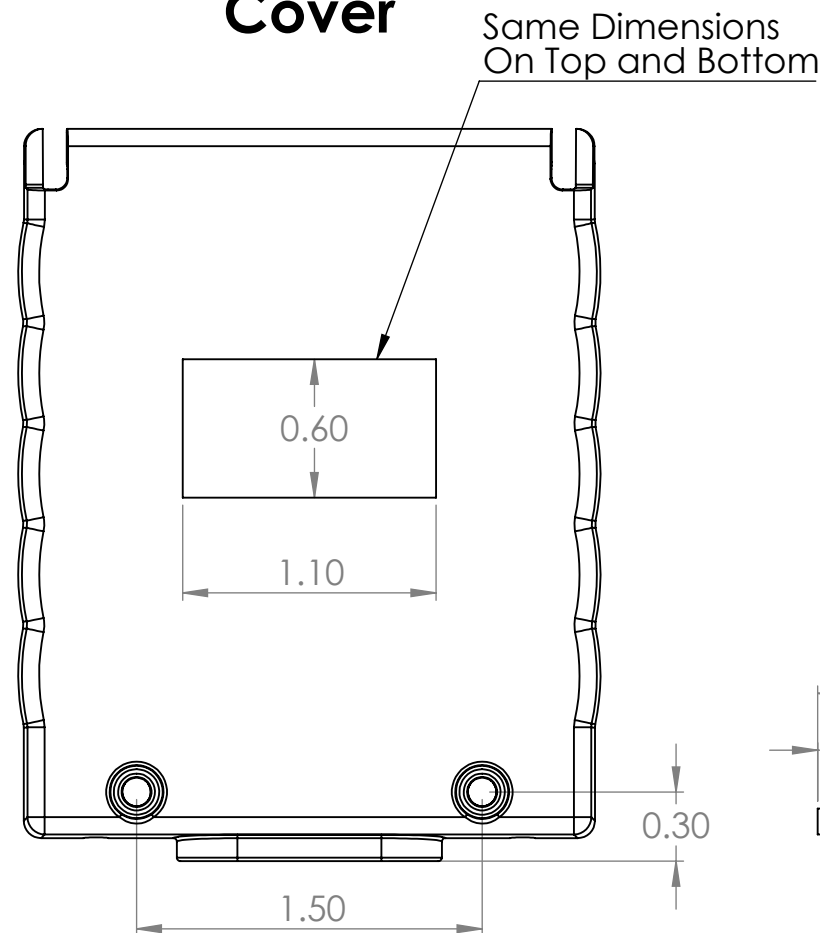

#4-40 Pan-Head, 5/8" For Case Enclosure (Qty:2)	
3.5MM OD x 5.5MM Snap Rivet For PCB Mounting (Qty: 2)	
0.1" Zip Tie, 4" For Wire Strain Relief (Qty:1)	

#4-40 Thumbscrew, 2.90"  
(Qty:2)

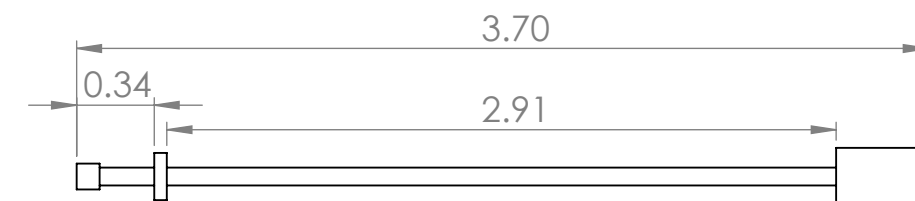

### Front Assembly

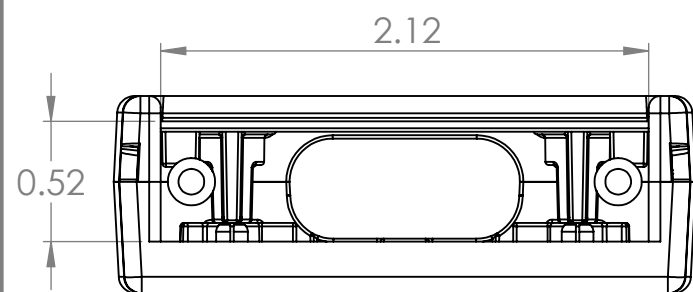

3.53 TYP

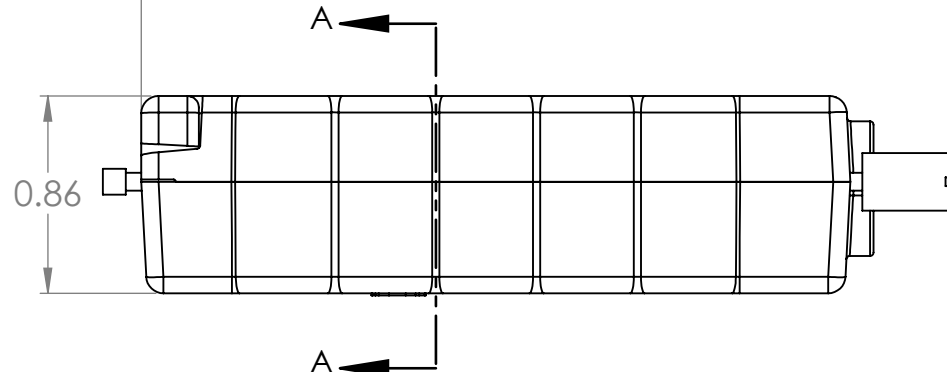

### Back Assembly

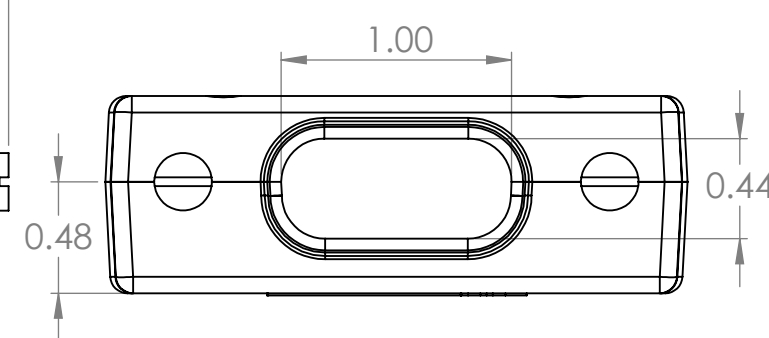

SECTION A-A

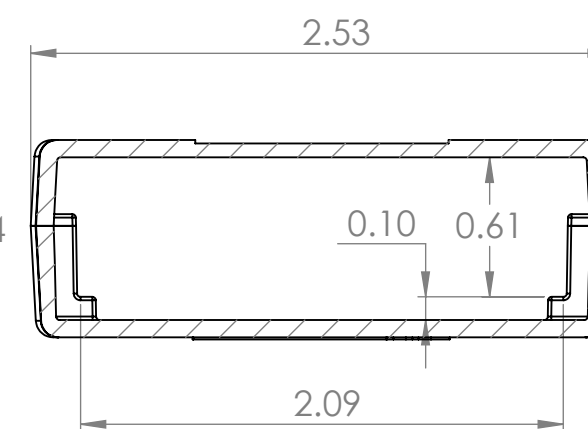

DIM: INCH	DATE: 02/25/2025	RoHS COMPLIANT: Yes	DESCRIPTION:
			DB44HD PCB Enclosure Kit
WINFORD ENGINEERING, LLC 4561 GARFIELD ROAD AUBURN, MI 48611			PART NUMBER (S)
www.winford.com			ECB25B1-T
989-671-9721			PART REVISION
			A